

Industrial Safety (EUR - List)

Teledyne Gas Measurement Instruments Ltd
Inchinnan Business Park
Renfrew
PA4 9RG
United Kingdom
Tel: +44 (0) 141 812 3211
www.teledynegasandflamedetection.com



Price List 2021

PS200 Series		Page
Instrument Specification		3
Filter Applications		4
Pricing - Instruments (Standard Filter)		5
Pricing - Instruments (Enhanced Filter)		6
Pricing - Instruments (Low Power LEL)		7
Pricing - Instruments (Marine)		8
Exploded Diagram		9
Pricing - Accessories		10
Pricing - Spare Parts		11
PS500 Series		
Instrument Specification		12
Pricing - Instruments		13
Pricing - Accessories		14
Pricing - Spare Sensors		15
Pricing - Other Spares		16
Automatic Bump Testing and Calibration (ABC)		
Stations Specification		17
Pricing - Spare Parts		18
Protégé ZM		
Instrument Specification		19
Pricing - Instruments & Accessories		20
Test Gas Cylinders		21

Note:

All prices are stated with reference to Teledyne GMI's current General terms and conditions of sale, unless otherwise agreed between the parties. Prices exclude carriage, insurance, VAT and other local taxes. Orders less than £75 or €75 or \$100 may be subject to a minimum order charge.



The PS200 Series detects all possible combinations of LEL, O₂, CO, H₂S, including single gas detection. In addition to displaying all gas readings simultaneously, the user can also initiate a manual bump test anytime.

Technical Specification

Size:	121 x 59 x 32mm (4.8" x 2.3" x 1.3")
Weight:	230g (8oz) with pump / 215g (7.6oz) without pump
Temperature:	-20°C to +50°C (-4°F to 122°F)
Humidity:	0 to 95% R.H non-condensing
Alarms:	Highly visible flashing LED, piercing >90dB audible
Display:	Green and red LCD backlight display
Datalogging:	Timed: Minimum of 6 months* Session: Minimum of 360 logs Calibration: Minimum of 8 calibration logs Bump Logs: Minimum of 360 logs
Battery:	Lithium Ion rechargeable battery Run Time: Up to 14 hrs (diffusion) Charging Time < 4 hrs
Enclosure:	High impact rubberized polycarbonate case
Drop Test:	3m (10ft)
IP Rating:	IP67 (Dust-tight and waterproof to 1m)
Response Times (T ₉₀):	LEL = 15 secs (IEC 60079-29-1) O ₂ = 12 secs (BSEN 50 104) CO <20 secs H ₂ S <20 secs
Approvals:	IEC Ex ia d IIC T4 Gb ATEX II 2G Ex ia d IIC T4 Gb CSA Class 1 Div 1 Groups A,B,C,D, T4 Class 1, Zone 1 EX ia d IIC T4 MED (0038/YY) - Module B & E CE European Mark of Conformity

* Based on 1 gas event every 1 hour during a typical 8-hour shift, with a datalogging interval of 1 minute.

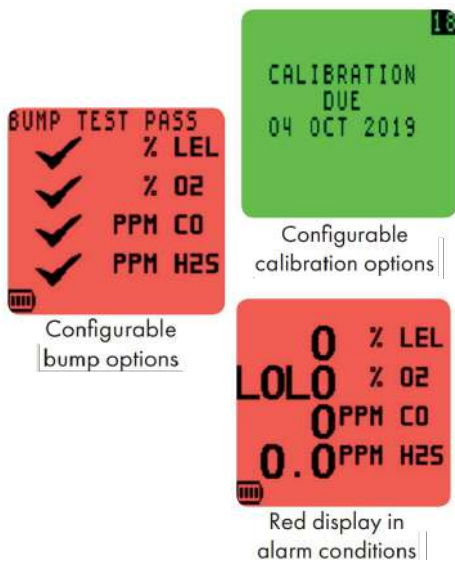

The following items are shipped as standard with each monitor:

- Charging/coms clip
- Universal charging adapter
- Calibration certificate
- Quick Operating instructions
- 3m tubing c/w quick connect (pumped only)





PS200 Series
Filter Applications



Applications	Standard Sensor	Enhanced Filter Sensor
	Detects most Combustible Gases	Enhanced resistance to H2S and Silicon Poisoning
Water Industry - Clean Water	✓	✓
Water Industry - Waste Water	✓	✓
BioDigester (high H ₂ S)	✓	✓
BioDigester (PPE)	✓	✓
Telecoms	✓	✓
Gas Welding/Brazing (acetylene)	✓	✓
Gas Welding/Brazing (propane)	✓	✓
Refining PPE	✓	✓
Petrochem (aromatics)	✓	✗
Petrochem ECO Fuels (alcohol) - tank farm	✓	✗
Gas transmission	✓	✓
Gas storage	✓	✓
Gas distribution	✓	✓
Oil exporation	✓	✓
Oil exploration (high H ₂ S)	✓	✓
Tank cleaning	✓	✓
Solvent recovery (aliphatic)	✓	✗
Solvent recovery (aromatic)	✓	✗
Power generation - electrical	✓	✓
Steel works - blast furnce	✓	✓
Steel works - soaking pits & reheat	✓	✓
Brewing	✓	✓
Distilling	✓	✗
Heat treatment (carburising/nitriding)	✓	✓
Certification gas groups - ATEX	ATEX IIC	ATEX IIC
Certification gas groups - UL	ABC & D	ABC & D



PS200 SERIES Instruments
(Standard Filter on LEL Sensor)



Part No	Description	€
---------	-------------	---

PUMPED Instruments

64141	4-Gas (LEL / O ₂ / H ₂ S / CO) Pumped	707.00
64131	3-Gas (LEL / O ₂ / H ₂ S) Pumped	560.00
64132	3-Gas (LEL / O ₂ / CO) Pumped	560.00
64133	3-Gas (LEL / H ₂ S / CO) Pumped	608.00
64134	3-Gas (O ₂ / H ₂ S / CO) Pumped	582.00
64121	2-Gas (LEL / O ₂) Pumped	412.00
64122	2-Gas (LEL / H ₂ S) Pumped	458.00
64123	2-Gas (LEL / CO) Pumped	458.00
64124	2-Gas (O ₂ / H ₂ S) Pumped	435.00
64125	2-Gas (O ₂ / CO) Pumped	435.00
64126	2-Gas (H ₂ S / CO) Pumped	490.00
64111	1-Gas LEL Pumped	355.00
64112	1-Gas O ₂ Pumped	328.00
64113	1-Gas H ₂ S Pumped	381.00
64114	1-Gas CO Pumped	381.00

NON-PUMPED Instruments

64041	4-Gas (LEL / O ₂ / H ₂ S / CO) Non-Pumped	646.00
64031	3-Gas (LEL / O ₂ / H ₂ S) Non-Pumped	497.00
64032	3-Gas (LEL / O ₂ / CO) Non-Pumped	497.00
64033	3-Gas (LEL / H ₂ S / CO) Non-Pumped	544.00
64034	3-Gas (O ₂ / H ₂ S / CO) Non-Pumped	521.00
64021	2-Gas (LEL / O ₂) Non-Pumped	348.00
64022	2-Gas (LEL / H ₂ S) Non-Pumped	396.00
64023	2-Gas (LEL / CO) Non-Pumped	396.00
64024	2-Gas (O ₂ / H ₂ S) Non-Pumped	373.00
64025	2-Gas (O ₂ / CO) Non-Pumped	373.00
64026	2-Gas (H ₂ S / CO) Non-Pumped	427.00
64011	1-Gas LEL Non-Pumped	283.00
64012	1-Gas O ₂ Non-Pumped	257.00
64013	1-Gas H ₂ S Non-Pumped	311.00
64014	1-Gas CO Non-Pumped	311.00

Customer Specials

64145	Customer Special - Refer GMI Sales
64045	Customer Special - Refer GMI Sales

- **Package includes:** quick op guide, universal PSU, comms cable, calibration certificate, 3m tubing (pumped only).
- **LEL sensor will respond to:** most combustible gases and vapours

Note: Place a 'B' in front of the Part Number if you require any of the below:

- Brazilian (INMETRO) certification
- Russian (GOST) certification
- Korean (KOSHA) certification



PS200 SERIES Instruments
(Enhanced Filter on LEL Sensor)



Part No	Description	€
---------	-------------	---

PUMPED Instruments

64141A	4-Gas (LEL / O ₂ / H ₂ S / CO) Pumped	707.00
64131A	3-Gas (LEL / O ₂ / H ₂ S) Pumped	560.00
64132A	3-Gas (LEL / O ₂ / CO) Pumped	560.00
64133A	3-Gas (LEL / H ₂ S / CO) Pumped	608.00
64121A	2-Gas (LEL / O ₂) Pumped	412.00
64122A	2-Gas (LEL / H ₂ S) Pumped	458.00
64123A	2-Gas (LEL / CO) Pumped	458.00
64111A	1-Gas LEL Pumped	311.00

NON-PUMPED Instruments

64041A	4-Gas (LEL / O ₂ / H ₂ S / CO) Non-Pumped	646.00
64031A	3-Gas (LEL / O ₂ / H ₂ S) Non-Pumped	497.00
64032A	3-Gas (LEL / O ₂ / CO) Non-Pumped	497.00
64033A	3-Gas (LEL / H ₂ S / CO) Non-Pumped	544.00
64021A	2-Gas (LEL / O ₂) Non-Pumped	348.00
64022A	2-Gas (LEL / H ₂ S) Non-Pumped	396.00
64023A	2-Gas (LEL / CO) Non-Pumped	396.00
64011A	1-Gas LEL Non-Pumped	283.00

- **Package includes:** quick op guide, universal PSU, comms cable, calibration certificate, 3m tubing (pumped only).
- **LEL sensor will respond to:** methane, ethane, propane, butane, pentane, hexane & hydrogen.

Note: Place a 'B' in front of the Part Number if you require any of the below:

- Brazilian (INMETRO) certification
- Russian (GOST) certification
- Korean (KOSHA) certification



PS200 SERIES Instruments
(Low Power LEL Sensor)



Part No	Description	€
---------	-------------	---

PUMPED Instruments

64141A3	4-Gas (LEL / O ₂ / H ₂ S / CO) Pumped	813.00
64131A3	3-Gas (LEL / O ₂ / H ₂ S) Pumped	643.00
64132A3	3-Gas (LEL / O ₂ / CO) Pumped	643.00
64133A3	3-Gas (LEL / H ₂ S / CO) Pumped	699.00
64121A3	2-Gas (LEL / O ₂) Pumped	474.00
64122A3	2-Gas (LEL / H ₂ S) Pumped	526.00
64123A3	2-Gas (LEL / CO) Pumped	526.00
64111A3	1-Gas LEL Pumped	408.00

NON-PUMPED Instruments

64041A3	4-Gas (LEL / O ₂ / H ₂ S / CO) Non-Pumped	742.00
64031A3	3-Gas (LEL / O ₂ / H ₂ S) Non-Pumped	573.00
64032A3	3-Gas (LEL / O ₂ / CO) Non-Pumped	573.00
64033A3	3-Gas (LEL / H ₂ S / CO) Non-Pumped	626.00
64021A3	2-Gas (LEL / O ₂) Non-Pumped	401.00
64022A3	2-Gas (LEL / H ₂ S) Non-Pumped	456.00
64023A3	2-Gas (LEL / CO) Non-Pumped	456.00
64011A3	1-Gas LEL Non-Pumped	325.00

- **Package includes:** quick op guide, universal PSU, comms cable, calibration certificate, 3m tubing (pumped only).
- **LEL sensor will respond to:** methane, ethane, propane, butane, pentane & hexane.

Note: Place a 'B' in front of the Part Number if you require any of the below:

- Brazilian (INMETRO) certification
- Russian (GOST) certification
- Korean (KOSHA) certification



PS200 SERIES Instruments
(Marine)



Part No	Description	€
---------	-------------	---

PUMPED Instruments

M64141	4-Gas (LEL / O ₂ / H ₂ S / CO) Pumped	Standard Filter LEL Sensor	707.00
M64141A	4-Gas (LEL / O ₂ / H ₂ S / CO) Pumped	Enhanced Filter LEL Sensor	707.00
M64131	3-Gas (LEL / O ₂ / H ₂ S) Pumped	Standard Filter LEL Sensor	560.00
M64131A	3-Gas (LEL / O ₂ / H ₂ S) Pumped	Enhanced Filter LEL Sensor	560.00
M64132	3-Gas (LEL / O ₂ / CO) Pumped	Standard Filter LEL Sensor	560.00
M64132A	3-Gas (LEL / O ₂ / CO) Pumped	Enhanced Filter LEL Sensor	560.00

NON-PUMPED Instruments

M64041	4-Gas (LEL / O ₂ / H ₂ S / CO) Non-Pumped	Standard Filter LEL Sensor	646.00
M64041A	4-Gas (LEL / O ₂ / H ₂ S / CO) Non-Pumped	Enhanced Filter LEL Sensor	646.00
M64031	3-Gas (LEL / O ₂ / H ₂ S) Non-Pumped	Standard Filter LEL Sensor	497.00
M64031A	3-Gas (LEL / O ₂ / H ₂ S) Non-Pumped	Enhanced Filter LEL Sensor	497.00
M64032	3-Gas (LEL / O ₂ / CO) Non-Pumped	Standard Filter LEL Sensor	497.00
M64032A	3-Gas (LEL / O ₂ / CO) Non-Pumped	Enhanced Filter LEL Sensor	497.00

- **Package includes:** quick op guide, universal PSU, comms cable, calibration certificate, 3m tubing (pumped only).
- **LEL sensor will respond to:** most combustible gases and vapours.

 **TELEDYNE**
GAS MEASUREMENT INSTRUMENTS
Everywhere you look™

PS200 Series
Exploded Diagram

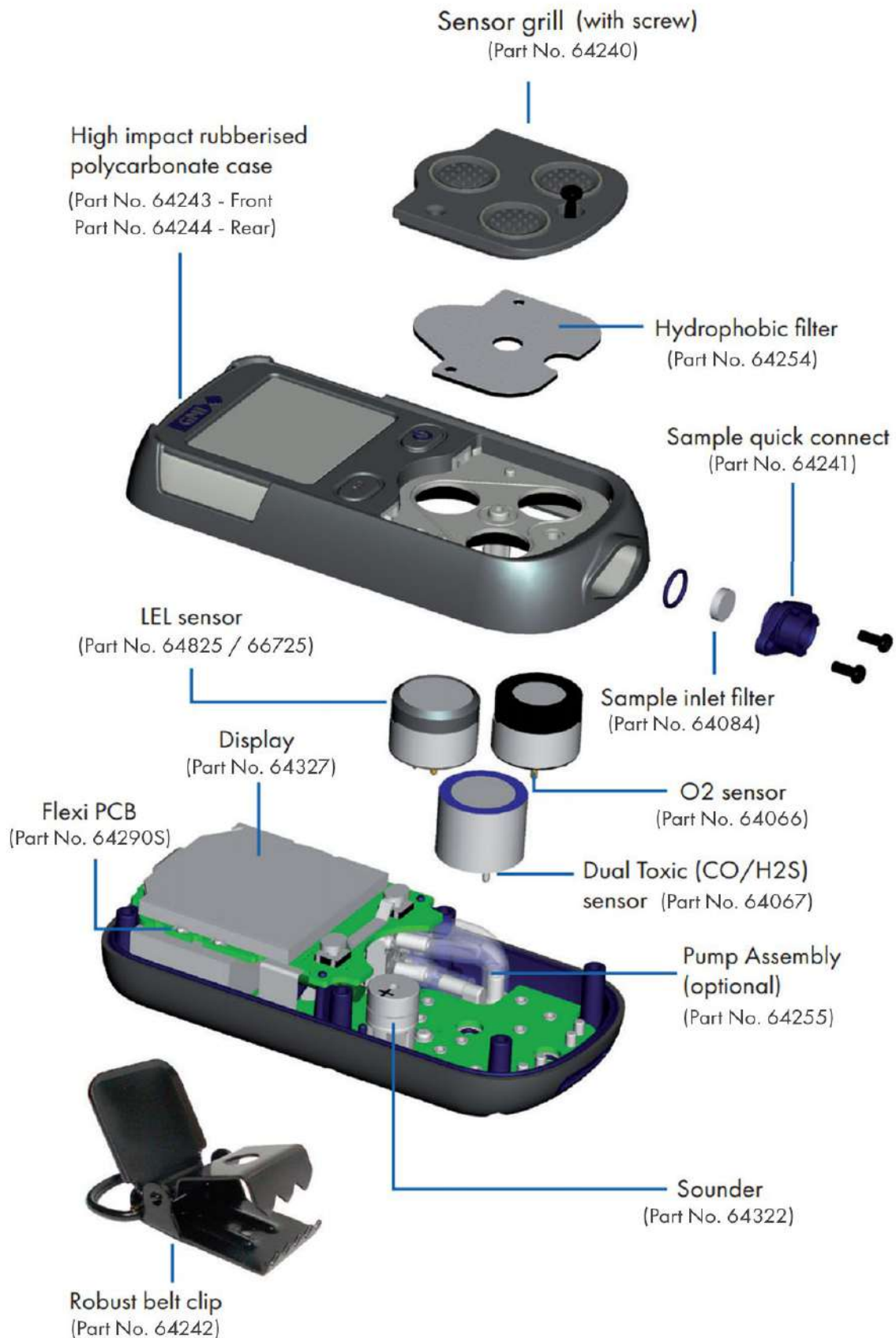



PS200 SERIES Instruments
Accessories, Calibration Equipment and Software



Part No	Description	€
---------	-------------	---

Accessories

64100	Hard Carrying Case	123.00
64270	PS200 vehicle charge kit	64.00
64491	PS200 Charging Cradle - USB 5V connection (surface mounted)	144.00
64560	PS200 Charging Cradle - 12V input (surface mounted)	144.00
64138	PS200 5-way charger	594.00
64303RD	Rubber Boot (Red)	25.20
64303BK	Rubber Boot (Black)	25.20
64303BU	Rubber Boot (Blue)	25.20
64303GN	Rubber Boot (Green)	25.20
64303GY	Rubber Boot (Grey)	28.80
64303OG	Rubber Boot (Orange)	28.80
64303YE	Rubber Boot (Yellow)	25.20
64260	Instrument Charging/comms clip	26.12
64247	Universal charging adaptor + USB cable	20.31
66123	Hand Aspirator	71.00
66478	Hand Aspirator c/w 3m tubing	96.00
66485	In Line hydrophobic filter assembly	22.04
66484	Hydrophobic Filter (for 66485)	12.06
64248	In vehicle charging adapter	35.91
64118	PVC Tubing (3 metre, use 66112 to extend)	9.12
64118R	PVC Tubing (price per metre, max length 30 metre)	3.04
64136	3 metres tubing c/w quick connect	14.12
64137	5 metres tubing c/w quick connect	20.20
66112	Sample Line Extender (to connect 1/8" sample line together)	2.44
66111	Sample Line Extender (to connect 1/8" to 3/16" sample line together)	2.81
66017	Probe assembly (unfiltered)	51.00
64108	Neck lanyard	7.03
64109	Probe assembly (filtered)	88.00

Bump Test and Calibration Equipment

64052	Auto Bump/Calibration Station * (6mm fittings including PSU/USB & software)	958.00
64052Q	Auto Bump/Calibration Station * (1/4" fittings including PSU/USB & software)	958.00
64051	Manual Bump Kit	403.00
99553	FlexiCal Plus (required for ABC Station in PC mode)	570.00
99560	PS200 Upgrade for FlexiCal IMS Network System Software (Allows PS200 ABC to work with existing IMS for Gasurveyor range)	802.00
99561	PS200 IMS (Full Install-Creates a PS200 specific IMS)	2409.00
64265	Tubing with 6mm push/fit	11.41
64438	Right angle 6 mm push in barb adaptor	8.23

* - requires Cal Gas Kit part no. 64060 or equivalent to operate

Gas Kits for Auto/Bump/Cal Station

99146	Combi Test Gas Cylinder (2.5% CH ₄ , 500ppm CO, 50ppm H ₂ S, 18% O ₂ , balance N ₂)	300.00
64060	Calibration Gas Kit (Combi test gas PN 99146, Demand Flow Regulator w/ tubing - for use w/ 64052(Q))	588.00

Software

64501	PS200 Setup Software (Instrument)	125.00
-------	-----------------------------------	--------



**PS200 SERIES Instruments
Spare Parts**



Part No	Description	€
---------	-------------	---

Spare Sensors

66725	LEL Standard Filter Sensor **	156.00
64825	LEL Enhanced Filter Sensor (-A) **	156.00
66750	LEL Low Power Sensor **	161.00
66761	LEL Low Power IR Sensor **	374.00
64066	O ₂ Sensor 2yr **	125.00
64128	H ₂ S Sensor **	256.00
64176	CO Sensor **	202.00
64067	Dual Toxic H ₂ S/CO Sensor **	283.00

Other Spare Parts

64172	Quick Op Instructions	6.51
64254	Hydrophobic Filter (c/w Gasket) **	7.98
64240	Filter Cover (c/w Captive Screw) **	5.65
64084	Sample Inlet Filter	1.81
64241	Inlet Nozzle (c/w Screws & O-Ring)	2.54
70314	Inlet Nozzle O-Ring (Min. Order Qty. 5-off)	0.45
64242	Jumbo Clip (c/w Screw)	32.62
66045	Sample Line Connector	4.62
24501	Screw - Front/Rear Cover (Min. Order Qty. 5-off)	0.35
64243	Front Cover **	40.57
64309	3 Cell Gasket **	3.66
64244	Rear Cover (Serial Number required) **	30.52
64255	Pump Kit **	119.00
64256	Diffusion Kit **	3.04
64329	O-ring 3mm (spare for 64255/64256, Min. Order Qty. 5-off) **	0.76
64327	Liquid Crystal Display (LCD) Module **	27.03
64290S	Three PCB Assembly (c/w Battery & LCD, but without man-down) * / **	187.00
24495	Screw (PCB) Pk5 (Min. Order Qty. 5-off) **	0.33
24732	Nylon Washer Pk5 (Min. Order Qty. 5-off) **	0.29
64322	Sounder **	7.05
64306	Button Spacer **	1.06
64260	Charging Comms Clip	26.12
64267	USB-A to mini-B cable assy	4.79

*- Serial Number of instrument is required for PCB supply

Demonstration Kits

64060	Calibration Gas Kit	588.00
-------	---------------------	--------

**** - CONTROLLED PARTS - To be replaced by qualified personnel only. Please contact your local Teledyne GMI representative for specific ordering information.**



The PS500 can be configured to detect up to five gases with its electrochemical and catalytic sensors, photo ionisation detectors (PID), and infrared capabilities.

“Plug and Play” maximises flexibility by allowing other gases to be detected, by simply inserting a new smart sensor assembly.

The PS500 is effective in noisy environments, featuring a loud (95dB) penetrating and distinctive audible alarm together with a high visibility visual alarm.

With a robust, rubberised casing guaranteeing Hi-Impact resistance, the PS500 is ideal for the most demanding industrial environments.

An Optional internal pump allows both pumped or diffusion measurements. If the pump is fitted, it can be easily turned on/off, depending on application. E.g. pump on to perform pre-entry measurements correctly, pump off for confined space working.

Technical Specification

Size:	140 x 85 x 45 mm / 5.5" x 3.3" x 1.7"
Weight:	0.4 kg / 14 oz.
Humidity:	0-98% non condensing
Alarms:	Visual 360° full light bar, piercing 95db audible 4 gas alarms per gas user programmable TWA/STEL alarms visual and audible Low flow visual and audible Low battery alarm Up to 4 alarms per toxic gas, user programmable 3 alarms for O ₂ , 2 alarms for LEL
Display:	LCD backlight display
Datalogging:	Timed: 24 hours of timed logs at 1 log per minute Session: Minimum of 180 logs Calibration: Minimum of 8 calibration logs
Sampling:	Maximum tubing length - 30 m / 98ft. (Response times increase by approx. 1 second for every metre / 3 ft. of tubing used)
Battery:	Rechargeable battery or alkaline battery pack (3xAA) minimum 12h runtime (with pump)
Enclosure:	High impact rubberized polycarbonate case
IP Rating:	IP65 (Dust tight and water resistant)
Approvals:	* UL 913 Class I, Div 1 Groups A,B,C,D MED (0038/YY) - Module B & E ATEX II 2 G EEx iad IIC T3 / T4 CE
IECEX:	EEx iad IIC T3/T4
Warranty:	2 years



Display in alarm conditions



VOC target gas selection



Configurable calibration options

* Excludes NDIR sensor

TELEDYNE GAS MEASUREMENT INSTRUMENTS <i>Everywhere you look™</i>	PS500 SERIES Instruments	
Part No	Description	€

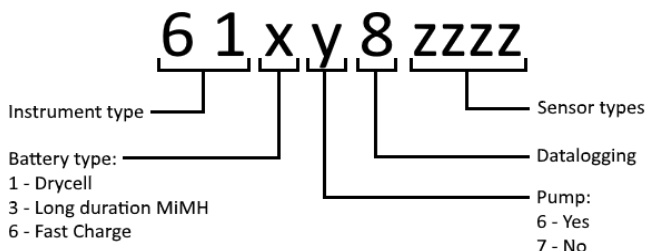

Instrument Pricing

61168	PS500 Drycell + Pump + Datalogging	578.00
61178	PS500 Drycell + Datalogging	371.00
61368	PS500 Long duration NiMH + Pump + Datalogging	681.00
61378	PS500 Long duration NiMH + Datalogging	475.00
61668	PS500 Fast Charge + Pump + Datalogging	793.00
61678	PS500 Fast Charge + Datalogging	587.00

Sensors

66825	A - LEL enhanced filter *	155.00
66725	A1 - LEL filtered	156.00
66625	A2 - LEL Carbon Cloth **	155.00
66066	B - O ₂	125.00
65128	C - H ₂ S	206.00
66285	C1 - H ₂ S <i>(use if LEL calibration is Ethanol / Methanol)</i>	206.00
65127	D - CO	206.00
66067	E - H ₂ S / CO <i>(5 gas instrument only with this dual sensor fitted)</i>	280.00
65377	F - SO ₂ (0-30ppm)	312.00
65371	G - CL ₂ ***	312.00
65378	H - NO ₂	312.00
65388	J - NH ₃ ***	475.00
65385	N - NO	312.00
66319	P - CO ₂ + <i>(Not UL approved)</i>	683.00
66346	R - Infrared LEL + <i>(Not UL approved)</i>	714.00
66559	U - PH ₃ ***	883.00
66559	V1 - VOC (0-100ppm) Isobutylene ***	883.00
66N579	V2 - VOC (0-1000ppm) Isobutylene ***	883.00
65377	X - SO ₂ (0-100ppm) <i>(Default HiHi alarm level 25ppm)</i>	312.00
66559	Z - Benzene (0-20ppm) ***	883.00

- * - Chemical filter. Methane, Propane, Butane, Pentane & Hydrogen calibration only.
- ** - Ensures only methane and hydrogen are not absorbed.
- *** - Instrument should include internal pump.
- + - Only one IR sensor can be fitted to an instrument.

Note: LEL sensors shall not be combined. Not even with an IR LEL.

Special Instruments

61371P	PS500 CO ₂ Long Duration + Datalogging <i>(Single gas version of diffusion PS500 with large font on screen.)</i>	1126.00
--------	--	---------

Package includes:

user CD, quick op guide, belt clip, calibration certificate, 3m tubing (pumped only), charger (Long Duration and Fast Charge only)



**PS500 SERIES Instruments
Accessories**



Part No	Description	€
---------	-------------	---

General Accessories

66123	Hand Aspirator (can be used for non-reactive gases only)	71.00
66118	Sample Line per Metre	9.74
66112	Sample Line Extender (to connect 1/8" sample line together)	2.44
66111	Sample Line Extender (to connect 1/8" to 3/16" sample line together)	2.81
66478	Hand Aspirator c/w 3m Sample Line	96.00
66136	3m Tygon Tubing c/w Sample Connector	34.11
66028	Neck Harness with Clip	24.37
66546	Neck and Chest Harness with Clip	64.00
66017	Probe Assembly	51.00
66349	Carrying Case	101.00
66545	Ball Float	41.41
66930	Reactive Gas Tubing (PTFE) Kit 3m	87.00
61540	Reactive Gas Tubing (Fluran) 1m	45.32
61536	Barb adapter	1.24

Chargers

66140	Charger (Universal Plug)	32.89
66200	5-way Standard Charger with Universal Plug	247.00
66207	10-way Standard Charger with Universal Plug	285.00
66206	12v / 24v Vehicle Charger Lead	32.89

Fast Chargers

66513	Fast Charger Single	229.00
66516	Fast Charger 10-way master, add 66514 to make 10 (requires mains cable)	707.00
30061	UK Mains Cable	45.22
13439	US Mains Cable	47.05
31048	EU Mains Cable	45.22
12020	AUS Main Cable	47.05
66514	Fast Charger (slave, goes with 66516, up to 9 max)	170.00
66209	USB-serial Adaptor	82.00

Software

61208	PS500 Datalogging Package (CD)	361.00
61445	PS500 Calibration Package	361.00

Note: The IR communication interface is included with the above software packages.

Bump Test and Calibration Equipment & Software

61502	Auto Bump/Calibration Station (Air + 1 gas inlet)	900.00
61504	Auto Bump/Calibration Station (Air + 3 gas inlets)	1201.00
61504R	Auto Bump/Calibration Station (Air + 3 gas inlets for reactive gases)	1323.00
99553	FlexiCal Plus Package for ABC stations (v1.2.0.0 or newer required)	570.00

Battery Packs

66702	Drycell Battery Pack	64.00
66701	Long Duration NiMH Battery Pack	164.00
66703	Fast Charge Battery Pack	230.00

PS500 Watcher

61700	Tablet & App installed (incl. Universal power adaptor)	804.00
61701W	PS500 Watcher instrument (Single Gas)	1211.00
61705W	PS500 Watcher instrument (Multigas)	1211.00
61720	Universal Power Adaptor	61.00



PS500 SERIES Instruments
Spare Sensors



Part No	Description	€
---------	-------------	---

Smart Sensor (Assembled and Calibrated)

66014	LEL enhanced filter * / ** <i>(State calibration gas when ordering)</i>	243.00
66022	LEL filtered ** <i>(State calibration gas when ordering)</i>	243.00
66070	LEL Carbon Cloth ** <i>(Hydrogen or Methane Only)</i>	243.00
66010	O ₂ **	210.00
66012	H ₂ S **	293.00
66013	CO **	293.00
66015	CO / H ₂ S **	495.00
66007	SO ₂ (0-30ppm) **	397.00
66575	SO ₂ (0-100ppm) ** <i>(default HiHi alarm level 25ppm)</i>	397.00
66006	CL ₂ **	397.00
66004	NO ₂ **	397.00
66005	NH ₃ **	561.00
66003	NO **	397.00
66571	PH ₃ **	954.00
66587	Benzene **	954.00
66588	VOC1 (0-100ppm) **	954.00
66589	VOC2 (0-1000ppm) **	954.00
66032	CO ₂ ** <i>(Not UL approved)</i>	845.00

* - Chemical filter. Methane, Propane, Butane, Pentane & Hydrogen calibration only.

Sensors only

66825	LEL enhanced filter **	155.00
66725	LEL filtered **	156.00
66625	LEL Carbon Cloth **	155.00
66066	O ₂ **	125.00
65128	H ₂ S **	206.00
66285	H ₂ S ** <i>(use if LEL calibration is Ethanol / Methanol)</i>	206.00
65127	CO **	206.00
66067	CO / H ₂ S **	280.00
65377	SO ₂ **	312.00
65371	CL ₂ **	312.00
65378	NO ₂ **	312.00
65388	NH ₃ **	475.00
65385	NO **	312.00
66559	PID (PH ₃ & VOC1 & Benzene) **	883.00
66N579	PID (VOC2) **	883.00
66346	IR LEL ** <i>(Not UL approved)</i>	714.00
66319	CO ₂ ** <i>(Not UL approved)</i>	683.00

Smart Sensor PCB only

66054	LEL enhanced filter **	49.93
66024	LEL filtered **	49.93
66000	LEL Carbon Cloth **	49.93
66052	O ₂ **	49.93
66057	H ₂ S **	49.93
66053	CO **	49.93
66055	CO / H ₂ S **	49.93
66050	SO ₂ (0-30ppm) **	49.93
66574	SO ₂ (0-100ppm) ** <i>(default HiHi alarm level 25ppm)</i>	49.93
66049	CL ₂ **	49.93
66215	NO ₂ **	49.93
66216	NH ₃ **	49.93
66214	NO **	49.93
66570	PH ₃ **	49.93
66586	Benzene **	49.93
66N771	VOC1 (0-100ppm) **	49.93
66N772	VOC2 (0-1000ppm) **	49.93
66325	CO ₂ **	121.00

**** - CONTROLLED PARTS - To be replaced by qualified personnel only. Please contact your local Teledyne GMI representative for specific ordering information.**



**PS500 SERIES Instruments
Other Spare Parts**



Part No	Description	€
---------	-------------	---

Spare Parts

66167	Instrument Key (T10)	14.86
66045	Sample Line Connector	4.62
66083	Sensor Hydrophobic Filter	13.03
66084	Sample Inlet Filter	2.44
66485	Hydrophobic Filter Assembly	22.04
66484	Hydrophobic Filter (for 66485)	12.06
66018	Probe End Piece	20.58
66019	Probe Extension Piece	30.93
85224	Probe Connector	9.86
66166	LD NiMH Battery allen key (2mm A/F)	2.93

66481	Secured protective cap (for 66701)	4.14
66692	Front Cover Moulding	49.56
66035	Rear Cover Assembly O-Ring	3.77
66159	Battery Pack O-Ring	0.98
66119	M3 Captive Screw for Battery Pack	3.90
24277	Flat Washer (for 66119)	0.70
66694	Belt Clip	5.12
24576	M3 Screws (2 required for 66694)	0.25
66700	Rubber Moulding Centre Chassis (including Buttons)	12.77
66704	Sensor Grille	12.29
66108	Sensor Blanking Plug **	2.93
64241	Inlet Nozzle (c/w Screws & O-Ring)	2.54
70314	Inlet Nozzle O-Ring (Min. Order Qty. 5-off)	0.45
66577	PID Cleaning Kit (includes removal tool) **	147.00
66578	PID Refurbishment Kit (for 0-100ppm range) **	331.00
61578	PID Refurbishment Kit (for 0-1000ppm range) **	331.00
66082	LCD Module **	67.00

61284	Main PCB (Datalogging, 5 Gas Version) **	355.00
-------	--	--------

Note: Serial Number of instrument is required for PCB supply

66190	Pump Kit (Pump & Tubing) **	226.00
66148	Tube Adaptor	3.29

66336	Fast Charger	210.00
66512	10-way Fast Charger	229.00
66515	Power Supply for 10-way Fast Charger	421.00
66255	5 way adaptor for mutiway charger	184.00
66220	10 way adaptor for multiway charger	226.00
66219	Power Supply for Multiway Charger (5 way & 10 way)	82.00
66349	Carry Case	101.00

**** - CONTROLLED PARTS - To be replaced by qualified personnel only. Please contact your local Teledyne GMI representative for specific ordering information.**

To complement the PS200 or PS500 instruments, the compact, robust and easy to use Auto Bump & Calibration Station provides bump and calibration options. Standalone mode is easy to install and configure and allows automatic record collection for certificate generation.

A special version of the PS500 ABC is available for reactive gases.

Each station can operate in three modes:

1. Standalone

- No PC or Network connection required
- Simple setup and configuration
- Results stored on ABC
- USB access for results extraction
- Settings App for easy printing of calibration certifications

3. Ethernet

- Multiple ABC's can be connected to a network
- Setup and configuration using GMI IMS Settings software
- All results stored on the IMS database
- Easy access to all results
- Powerful data management / calibration certificate generation

2. PC

- PC connected directly to ABC
- Setup and configuration using GMI flexiCal Plus software
- Results stored on the PC
- Easy access to all results
- Powerful data management / calibration certificate generation



Technical Specification

Size:	200 x 140 x 135mm (7.9" x 5.5" x 5.3")
Weight:	Single Gas - 1.2kg (43oz) Multi Gas - 1.35kg (48oz) - PS500 version only
Interfaces:	Standalone / USB / Ethernet
LED indicators:	Power (Green) Testing (Orange) Pass (Green) Fail (Red)
Testing time:	PS200: Bump Test = 60s / Calibration = 90s PS500: Bump Test = 150s / Calibration = 150s
Data Storage:	>6000 Bump & Calibration Results
Power Supply:	12V dc, 2A
Operating Temperature:	-10°C to +40°C (14°F to 104°F)
Gas Ports:	PS200: 3 (Air, Combi Gas & Exhaust) PS500: Single Gas - 3 (Air, Gas & Exhaust) Multi Gas - 5 (Air, 3x Gas & Exhaust)



**Auto Bump & Calibration Stations
Spare Parts**



Part No	Description	€
---------	-------------	---

PS200 ABC - Product-Specific Spare Parts

64292	Compartment PCBA * / **	102.00
14911S	SODIMM Module * / **	208.00
64407	Insert Moulding **	54.00
64408	LDR window (1pc) **	4.92
64441	ABC operating label ** <i>(use on front lid)</i>	7.50
64415	Internal Bracket **	30.60
64184	Spare Memory Stick (includes software)	40.54

* - Serial Number of the station is required for PCB supply

PS500 ABC - Product-Specific Spare Parts

61052	Compartment PCBA * / **	102.00
61511	Insert Moulding **	54.00
61512	LDR window **	7.50
61285	ABC operating label ** <i>(use on front lid)</i>	15.90
61525	Pump Assembly ** <i>(for reactive gases ABC)</i>	190.00
14690	Fluran Tubing ** <i>(for reactive gases ABC)</i>	30.00
61524	Manifold Assembly (1x Air + 3x Gas) **	522.00
61513	Internal Bracket (3x Gas) **	35.40
64415	Internal Bracket (1x Gas) **	30.60
61251	Spare Memory Stick (includes software)	40.54

* - Serial Number the station is required for PCB supply

Common spare parts for all ABC Stations

64291	Main PCBA **	153.00
64416	Center Moulding **	50.40
64413	Base Moulding **	68.00
64275	Nozzle Block Assembly **	31.20
75081	Nozzle O-Ring <i>(use with 64275)</i>	0.52
24276	M3 Flat Washer ** <i>(use with 64416 & 61511)</i>	0.25
24790	4x3/8" Self Tap Pozi screw ** <i>(use with 64416 & 61511)</i>	0.25
64412	Lid Moulding **	23.40
14143	Nylon Washer ** <i>(use with 64412 - 4pcs needed)</i>	0.25
64487	Latch Stopper **	7.80
24925	M3x8 Pozi Pan Screw ** <i>(use with 64487)</i>	0.25
64279	Latch Assembly	21.48
64277	Pump Assembly * / **	270.00
51231	Ribbon Cable **	19.80
64278	Switch Assembly **	13.08
64276	Solenoid Assembly **	154.00
64439	6mm Bulkhead Inlet Fittings **	7.45
61513	Internal Bracket **	35.40
67347	Power Supply - Auto Bump Station	29.54

* - Not suitable for reactive gases

**** - CONTROLLED PARTS - To be replaced by qualified personnel only. Please contact your local Teledyne GMI representative for specific ordering information.**



The Protégé ZM Single Gas monitor is an easy-to-use, zero maintenance gas detector that is available for oxygen, carbon monoxide or hydrogen sulphide.

Once activated, the Protégé ZM monitor does not require charging or calibration. These monitors can be deployed in the field 24 hours a day, every day for two years, maintenance and hassle free.

Customizable Settings

- Custom or factory-programmed alarm set points
- User configurable bump and calibration reminders
- Multiple LCD display options including real-time gas readings, monitor life remaining or both
- Three point alarms (audible, visual and tactile)
- Datalogging capabilities
- Name or assign monitors using a six-character user ID

Accessories



STATIONARY TEST STATION



PROTÉGÉ ZM CONFIGURATION SOFTWARE



IR CONNECT MODULE

Technical Specification

Size:	3.7" H x 2.2" W x 1.3" D"
Weight:	2.7 Oz
Humidity:	5-95% RH non condensing
Temperature:	-30°C to +50°C (O ₂) -40°C to +50°C (H ₂ S) -50°C to +50°C (CO)
Ranges:	CO: 1-300 ppm H ₂ S: 1-100 ppm O ₂ : 1-30% vol
Alarms:	Visual - Red LED Audible - 95db buzzer Vibrating
Display:	LCD display
Datalogging:	Logs last 25 events
Enclosure:	Impact-absorbant rubber overmold
IP Rating:	IP66/67
Approvals:	CSA Class 1, Div 1 Groups A,B,C,D T4 ATEX II 1 G Ex ia IIC T4 G4 IECEX Ex ia IIC T4 Ga EAC CE



Protégé ZM
Instruments & Accessories



Part No	Description	€
---------	-------------	---

Instrument (standard alarms)

2025937	Protégé ZM H ₂ S <i>Alarms (ppm): Hi 10, HiHi 15</i>	140.00
2025938	Protégé ZM CO <i>Alarms (ppm): Hi 35, HiHi 200</i>	140.00
2025939	Protégé ZM O ₂ <i>Alarms (%): Hi 23.5, Lo 19.5</i>	140.00

Instrument (custom alarms) * - longer lead-time

2026300	Protégé ZM H ₂ S	140.00
2026299	Protégé ZM CO	140.00
2026301	Protégé ZM O ₂	140.00

* - Please specify required alarms settings when ordering.

Instrument (standard alarms) + EAC certification

2030370	Protégé ZM H ₂ S <i>Alarms (ppm): Hi 10, HiHi 15</i>	140.00
2030359	Protégé ZM CO <i>Alarms (ppm): Hi 35, HiHi 200</i>	140.00
2030360	Protégé ZM O ₂ <i>Alarms (%): Hi 23.5, Lo 19.5</i>	140.00

Instrument (custom alarms) * + EAC certification - longer lead-time

2030472	Protégé ZM H ₂ S	140.00
2030471	Protégé ZM CO	140.00
2030473	Protégé ZM O ₂	140.00

* - Please specify required alarms settings when ordering.

- **Package includes:** stainless steel clip, calibration cup, calibration certificate, quick operation guide.

Accessories

2025940	IR Connect with USB cable	80.00
2025958	IR Connect - spare USB cable	5.00
2025957	Belt clip, alligator style	5.00
2025956	Calibration cup	2.00
2026298	USB memory stick	20.00

Calibration Equipment & Test Gas

2019125	Fix flow regulator 0.5 l/min	125.00
12712	Tygon tubing 1 m / 3 ft	10.37
2019127	H ₂ S cylinder (25ppm)	155.00
99167	CO cylinder (100ppm)	215.00
2026297	O ₂ cylinder (16%)	150.00



Test Gas Cylinders
(disposable pressurised cans without regulators)



Part No	Description	€
---------	-------------	---

103 litre cylinders

Balance Gas

99171	10ppm Methane	Air	215.00
99125	800ppm Methane	Air	215.00
99127	0.45% Methane	Air	215.00
99121	1% Methane	Air	215.00
077-0358	1.62% Methane	Air	156.00
99159	2.5% Methane / 18% O ₂	Nitrogen (N ₂)	215.00
99130	2.5% Methane / 100ppm CO / 18% O ₂	Nitrogen (N ₂)	215.00
99169	2.5% Methane / 50ppm CO	Air	215.00
99129	100% Methane	-	215.00
99132	800ppm Propane	Air	215.00
99133	1% Propane / 18% O ₂	Nitrogen (N ₂)	215.00
99122	0.075% Butane	Air	215.00
99137	0.75% Butane	Air	215.00
99120	0.89% Butane / 18% O ₂	Nitrogen (N ₂)	215.00
99140	800ppm Pentane	Air	215.00
99141	0.7% Pentane / 18% O ₂	Nitrogen (N ₂)	215.00
99123	96ppm Hydrogen	Air	215.00
99124	800ppm Hydrogen	Air	215.00
99126	2% Hydrogen	Air	215.00
99157	Hydrocarbon-Free Air (20.9% O ₂ in N ₂)	Nitrogen (N ₂)	215.00
99166	0.5% CO ₂	Air	215.00
99161	1% CO ₂	Air	215.00
99163	3% CO ₂	Air	215.00
99165	100% CO ₂	Air	215.00
99167	100ppm CO	Air	215.00
99145	500ppm CO	Air	215.00
99160	100% Nitrogen (N ₂)	-	215.00
99176	50ppm Isobutylene	Air	215.00
99178	500ppm Isobutylene	Air	215.00

58 litre cylinders

Balance Gas

99143	50ppm Hydrogen Sulphide (H ₂ S)	Nitrogen (N ₂)	300.00
99147	10ppm Sulphur Dioxide (SO ₂)	Air	300.00
99148	10ppm Ethylene Oxide (C ₂ H ₄ O)	Nitrogen (N ₂)	300.00
99149	20ppm Nitrogen Dioxide (NO ₂)	Air	300.00
077-0203	25ppm Nitric Oxide (NO)	Nitrogen (N ₂)	254.00
077-0151	2ppm Chlorine (Cl ₂)	Nitrogen (N ₂)	312.00
99151	10ppm Chlorine (Cl ₂)	Nitrogen (N ₂)	300.00
99153	50ppm Ammonia (NH ₃)	Nitrogen (N ₂)	300.00
99173	20ppm Hydrogen Cyanide (HCN)	Nitrogen (N ₂)	300.00
99144	2.5% Methane / 100ppm CO / 25ppm H ₂ S	Air	300.00
99146	2.5% Methane / 500ppm CO / 50ppm H ₂ S / 18% O ₂	Nitrogen (N ₂)	300.00
99177	1% Propane / 100ppm CO / 25ppm H ₂ S	Air	300.00
99152	50ppm H ₂ S / 500ppm CO / 0.75% Butane / 18% O ₂	Nitrogen (N ₂)	300.00
99154	50ppm H ₂ S / 500ppm CO / 1% Propane / 18% O ₂	Nitrogen (N ₂)	300.00
99156	50ppm H ₂ S / 500ppm CO / 0.7% Pentane/ 18% O ₂	Nitrogen (N ₂)	300.00

Accessories

99116	Balanced Flow Regulator	<i>(use with pumped instruments)</i>	187.00
99117	Direct Flow Regulator **	<i>(use with non-pumped instruments)</i>	187.00
99118	Demand Flow Regulator	<i>(use with pumped instruments)</i>	484.00
48118	Demand Flow Regulator with quick connect tubing		517.00
99103	Carrying Case		164.00
99107	Pressure Gauge		178.00
67071	Gas bottle clip (wall mountable)		16.24

** - The pump on the VISA, PS500 and PS200 is always OFF during manual calibration, so the "Direct Flow Regulator" should be used those instruments.



TELEDYNE
GAS MEASUREMENT INSTRUMENTS
Everywhereyoulook™



AMERICAS

14880 Skinner Road,
Cypress,
TX 77249, USA
Tel.: +1-713-559-9200
Fax.: +1-713-893-6729

EMEA

Inchinnan Business Park,
Renfrew,
PA4 9RG,
United Kingdom
Tel.: +44 (0) 141 812 3211

ASIA PACIFIC

Teledyne Singapore Pte Ltd
750C Chai Chee Road
#03-08 Viva Business Park
Singapore 469003
Tel: +65 84282741

www.teledynegasandflamedetection.com



Copyright © 2020 Teledyne Technologies.
All rights reserved.